

KPL25-1A

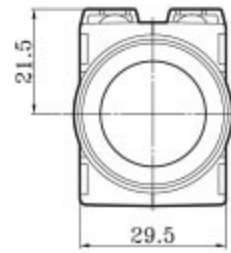

KPL25F(W)-1A

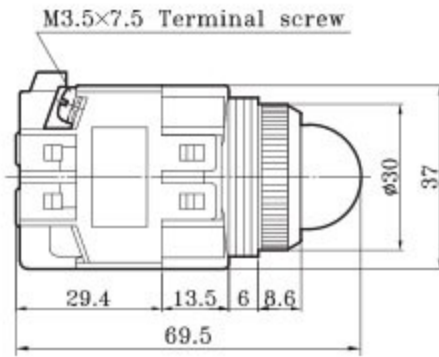
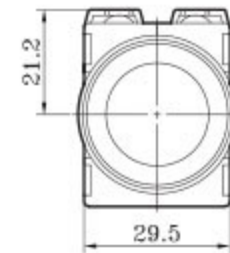
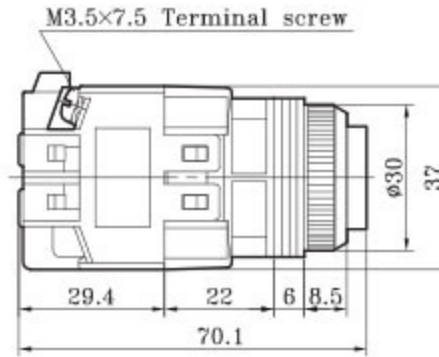

KPL25-1C

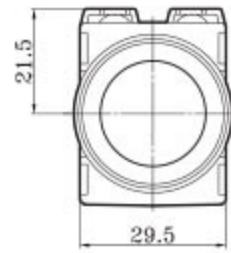
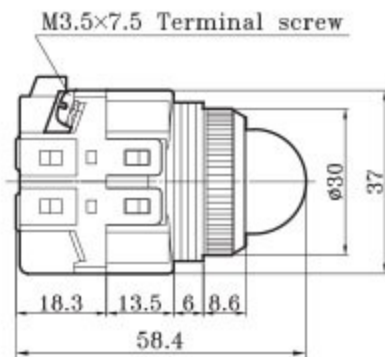

KPL25F(W)-1C

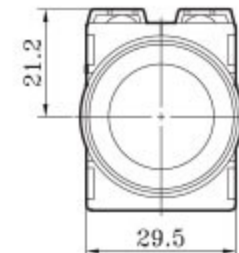
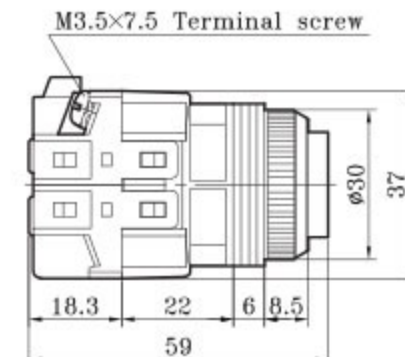

KPL30-1A

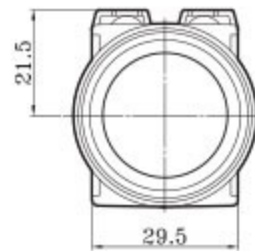
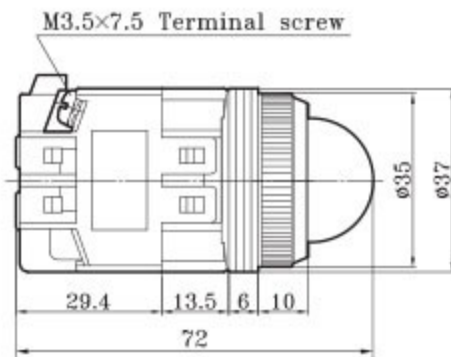

Panel cut-out

KPL25일 때

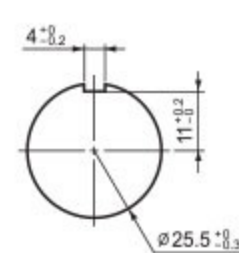

KPL30일 때

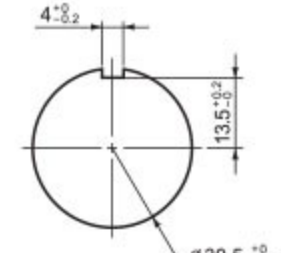

KPL30-1C

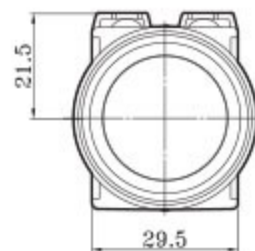
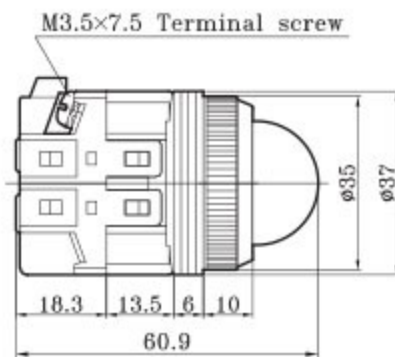

■ 트랜스포머의 2차 출력전압은 6V입니다.

■ 재질 : 바디 : Nylon glass

링 : ABS, 캡 : AS

■ 알루미늄링은 별도 판매합니다.